

OUVERTURE DU LIT OPENING BED

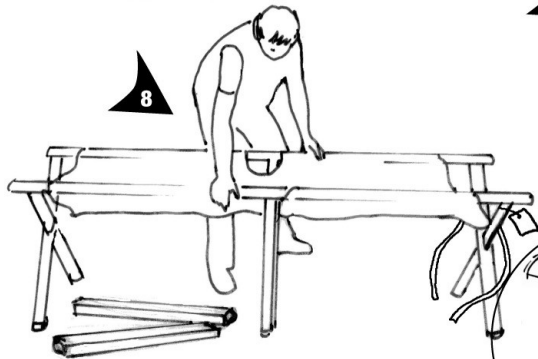

Ouvrir le lit et attacher l'étiquette d'identification du lit au dessus d'une des sangles servant d'attache au lit

Open the cot and attach the identification ticket above one of the straps used for tying the cot

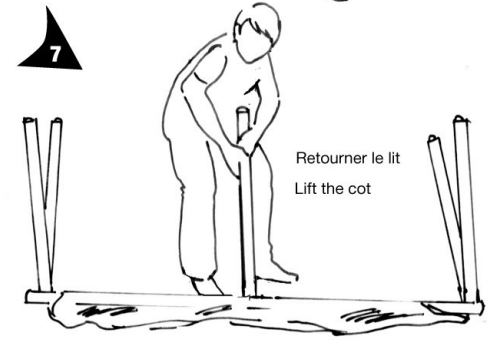
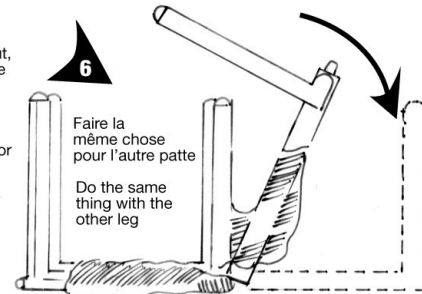
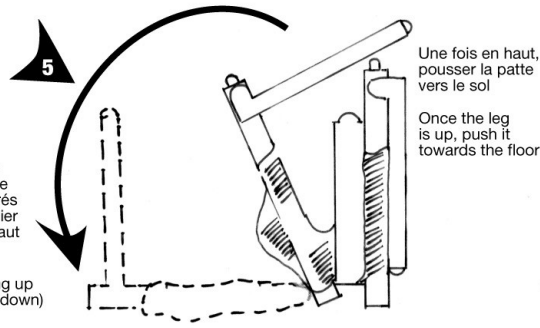
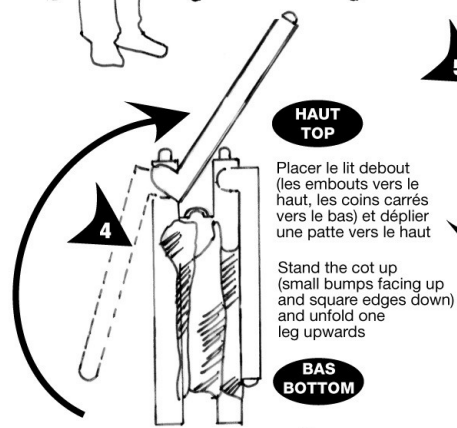
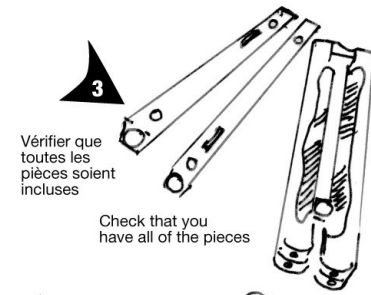
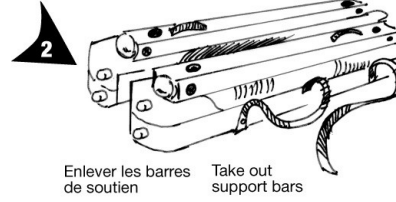
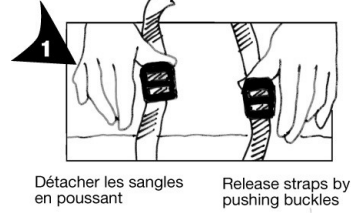
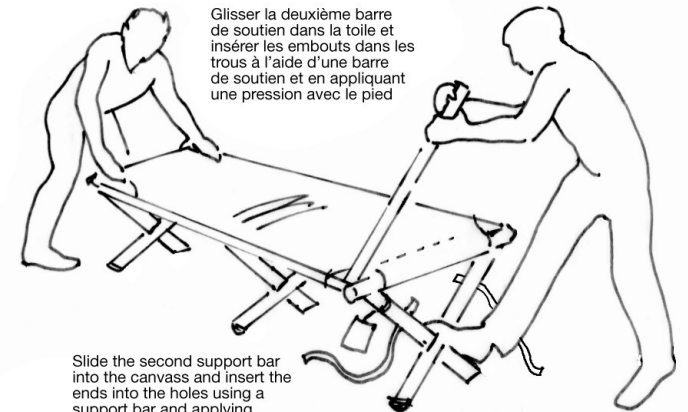
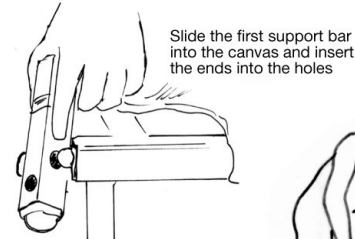
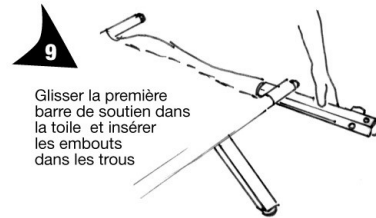

Slide the second support bar into the canvas and insert the ends into the holes using a support bar and applying pressure with your foot

Astuces :

- Attention! Protéger vos mains
- Suivre les directives attentivement

Helpful Hints:

- Make sure to protect your hands!
- Follow the directions carefully



11

FERMETURE DU LIT
CLOSING THE BED

Déclencher la première barre de soutien à l'aide d'une autre barre et en appliquant une pression avec le pied

Release the first supporting bar by using another bar and applying pressure with your foot

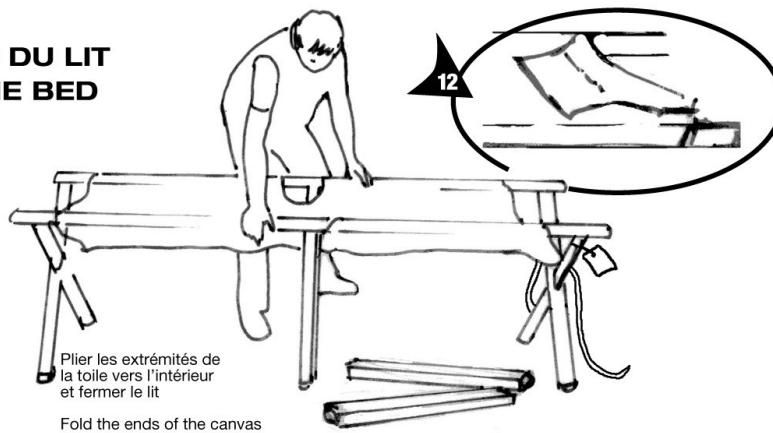

Plier les extrémités de la toile vers l'intérieur et fermer le lit

Fold the ends of the canvas towards the inside and close the cot

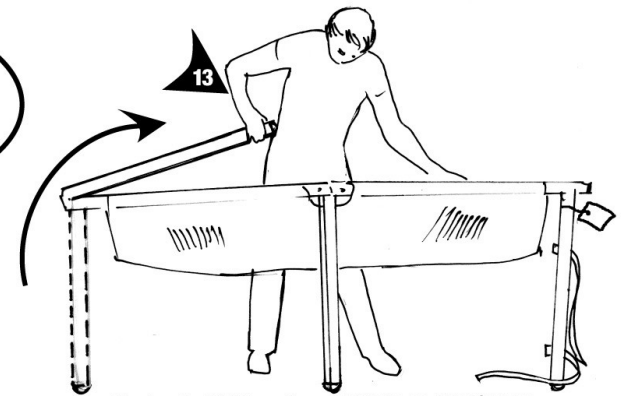

Plier la patte SANS sangle vers le dessus du lit

Fold the leg WITHOUT the straps up on top of the cot

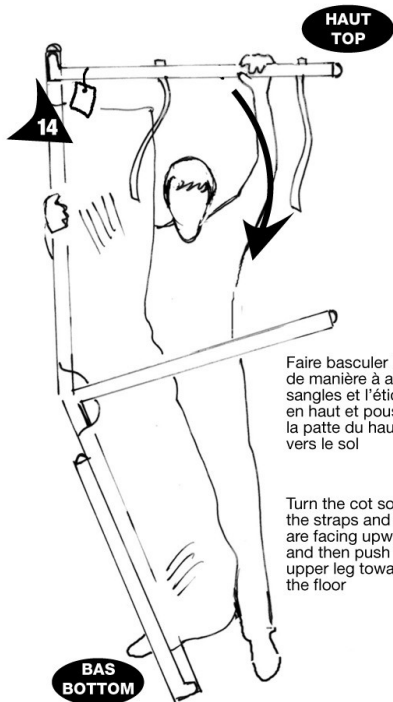

Faire basculer le lit de manière à avoir les sangles et l'étiquette en haut et pousser la patte du haut vers le sol

Turn the cot so that the straps and ticket are facing upwards and then push the upper leg towards the floor

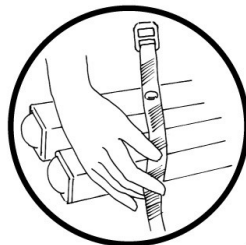

ATTENTION :
Ne pliez pas les sangles dans les pattes !
Don't let the straps get folded in the legs!

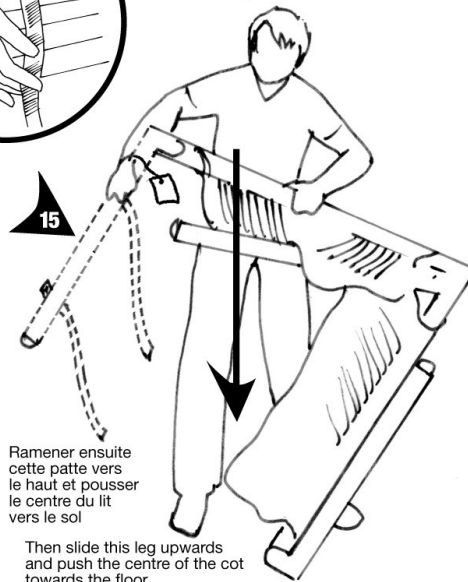

Ramener ensuite cette patte vers le haut et pousser le centre du lit vers le sol

Then slide this leg upwards and push the centre of the cot towards the floor

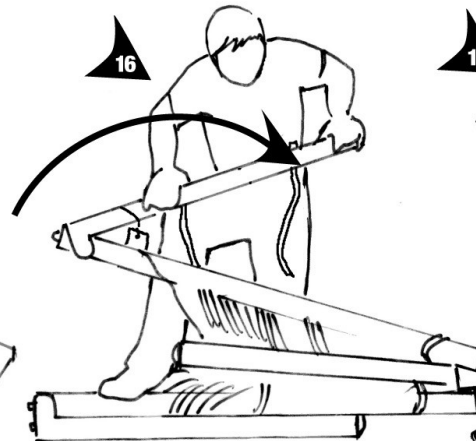

Rabattre la patte jusqu'au sol en évitant de coincer l'étiquette et les ganses entre deux pattes du lit

Push the leg back towards the floor making sure you don't jam the ticket or the end flaps between the two legs of the cot

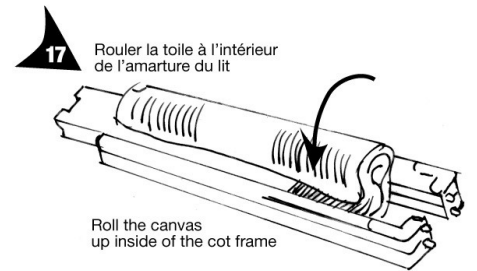

Rouler la toile à l'intérieur de l'armature du lit

Roll the canvas up inside of the cot frame

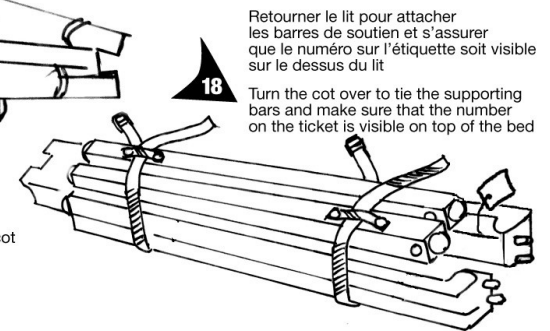

Retourner le lit pour attacher les barres de soutien et s'assurer que le numéro sur l'étiquette soit visible sur le dessus du lit

Turn the cot over to tie the supporting bars and make sure that the number on the ticket is visible on top of the bed

BAS
BOTTOM

HAUT
TOP